

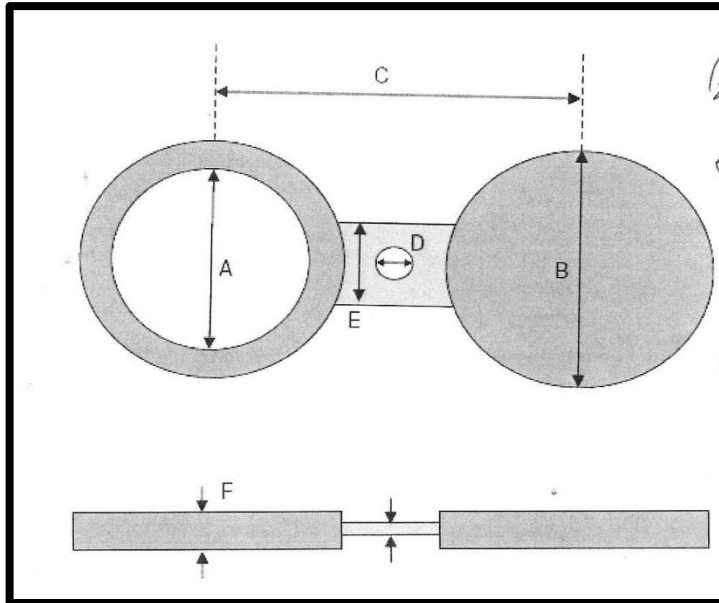

## RAISED FACE SPECTACLE BLIND



- STANDARD DIMENSIONS AS PER ASME B16.48
- HOLE SIZE SHALL BE SAME AS THE FLANGE BOLT HOLE AND LOCATED SUCH THAT IS WILL NOT INTERFERE WITH BOLTING BETWEEN FLANGES
- THE THICKNESS OF HANDLE OR WEB (TIE BAR) SHALL BE CAPABLE OF SUPPORTING HEIGHT OF ALL ORIENTATIONS.
- MATERIALS INCLUDE: A516-70; 304SS; 316SS; AND OTHER EXOTIC ALLOYS
- GASKET SURFACES: SMOOTH FINISH; MILL FINISH; MACHINED FINISH (100-500 AARH)
- PADDLE BLINDS AND SPACER RINGS ALSO AVAILABLE ACCORDING TO B16.48



# RAISED FACE SPECTACLE BLIND

## DIMENSIONS

PIPE SIZE	150# FLANGES					
	A	B	C	D	E	F
1/2"	0.625	1-3/4	2-3/8	5/8	1-1/2	1/4
3/4"	0.813	2-1/8	2-3/4	5/8	1-1/2	1/4
1"	1-1/8	2-1/2	3-1/8	9/16	1-1/2	1/4
1-1/4"	1-5/8	2-7/8	3-1/2	9/16	1-1/2	1/4
1-1/2"	1-7/8	3-1/4	3-7/8	9/16	1-1/2	1/4
2"	2-3/8	4	4-3/4	11/16	2	1/4
2-1/2"	2-7/8	4-3/4	5-1/2	11/16	2	1/4
3"	3-1/2	5-1/4	6	11/16	2-1/2	1/4
3-1/2"	4	6-1/4	7	3/4	2-1/2	3/8
4"	4-1/2	6-3/4	7-1/2	3/4	2-1/2	3/8
5"	5-9/16	7-5/8	8-1/2	7/8	3	3/8
6"	6-5/8	8-5/8	9-1/2	7/8	3	1/2
8"	8-5/8	10-7/8	11-3/4	7/8	3	1/2
10"	10-3/4	13-1/4	14-1/4	1	4	5/8
12"	12-3/4	16	17	1	4	3/4
14"	14	17-5/8	18-3/4	1-1/8	4-1/4	3/4
16"	16	20-1/8	21-1/4	1-1/8	4-1/4	7/8
18"	18	21-1/2	22-3/4	1-1/4	4-1/2	1
20"	20	23-3/4	25	1-1/4	4-3/4	1-1/8
24"	24	28-1/8	29-1/2	1-3/8	5-1/2	1-1/4

PIPE SIZE	300# FLANGES					
	A	B	C	D	E	F
1/2"	5/8	2	2-5/8	5/8	1-1/2	1/4
3/4"	4/5	2-1/2	3-1/4	3/4	1-1/2	1/4
1"	1-1/8	2-3/4	3-1/2	11/16	1-1/2	1/4
1-1/4"	1-5/8	3-1/8	3-7/8	11/16	1-1/2	1/4
1-1/2"	1-7/8	3-5/8	4-1/2	7/8	2	1/4
2"	2-3/8	4-1/4	5	3/4	2	3/8
2-1/2"	2-7/8	5	5-7/8	7/8	2-1/2	3/8
3"	3-1/2	5-3/4	6-5/8	7/8	2-1/2	3/8
3-1/2"	4	6-3/8	7-1/4	7/8	2-1/2	1/2
4"	4-1/2	7	7-7/8	7/8	2-1/2	1/2
5"	5-9/16	8-3/8	9-1/4	7/8	3	5/8
6"	6-5/8	9-3/4	10-5/8	7/8	3	5/8
8"	8-5/8	12	13	1	3-1/2	7/8
10"	10-3/4	14-1/8	15-1/4	1-1/8	4	1
12"	12-3/4	16-1/2	17-3/4	1-1/4	4	1-1/8
14"	14	19	20-1/4	1-1/4	4-3/4	1-1/4
16"	16	21-1/8	22-1/2	1-3/8	4-7/8	1-1/2
18"	18	23-3/8	24-3/4	1-3/8	4-1/2	1-5/8
20"	20	25-5/8	27	1-3/8	4-3/4	1-3/4
24"	24	30-3/8	32	1-5/8	5-1/2	2

PIPE SIZE	600# FLANGES					
	A	B	C	D	E	F
1/2"	5/8	2	2-5/8	5/8	1-1/2	1/4
3/4"	13/16	2-1/2	3-1/4	3/4	1-1/2	1/4
1"	1-1/8	2-3/4	3-1/2	3/4	2-1/4	1/4
1-1/4"	1-7/16	3-1/8	3-7/8	3/4	2-1/4	3/8
1-1/2"	1-11/16	3-5/8	4-1/2	7/8	2-5/8	3/8
2"	2-1/8	4-1/4	5	3/4	2-1/4	3/8
2-1/2"	2-5/8	5	5-7/8	7/8	2-5/8	1/2
3"	3-1/4	5-3/4	6-5/8	7/8	2-5/8	1/2
3-1/2"	3-3/4	6-1/4	7-1/4	1	3	5/8
4"	4-1/4	7-1/2	8-1/2	1	3	5/8
5"	5-1/4	9-3/8	10-1/2	1-1/8	3-3/8	3/4
6"	6-3/8	10-3/8	11-1/2	1-1/8	3-3/8	7/8
8"	8-3/8	12-1/2	13-3/4	1-1/4	3-3/4	1-1/8
10"	10-7/16	15-5/8	17	1-3/8	4-1/8	1-3/8
12"	12-3/8	17-7/8	19-1/4	1-3/8	4-1/8	1-5/8
14"	13-5/8	19-1/4	20-3/4	1-1/2	4-1/2	1-3/4
16"	15-5/8	22-1/8	23-3/4	1-5/8	4-7/8	2
18"	17-5/8	24	25-3/4	1-3/4	5-1/4	2-1/8
20"	19-5/16	26-3/4	28-1/2	1-3/4	5-1/4	2-1/2
24"	23-1/2	31	33	2	6	2-7/8

PIPE SIZE	900# FLANGES					
	A	B	C	D	E	F
1/2"	0.625	2.375	3.25		1.5	0.25
3/4"	0.0825	2.625	3.5	0.875	1.625	0.25
1"	1.05	3	4	1	2.25	0.25
1-1/4"	1.44	3.375	4.375	1	2.25	0.375
1-1/2"	1.68	3.5	4.875	1.125	2.625	0.375
2"	2.16	5.5	6.5	1	2.25	0.50
2-1/2"	2.64	6.375	7.5	1.125	2.625	0.50
3"	3.25	6.5	7.5	1	2.625	0.63
4"	4.25	8	9.25	1.25	3	0.75
5"	5.3	9.625	11	1.375	3.375	0.88
6"	6.36	11.25	12.5	1.25	3.375	1
8"	8.33	14	15.5	1.5	3.75	1-3/8
10"	10.42	17	18.5	1.5	4.125	1-5/8
12"	12.39	19.5	21	1.5	4.125	1-7/8
14"	13.62	20.375	22	1.625	4.5	2-1/8
16"	15.62	22.5	24.25	1.75	4.875	2-3/8
18"	17.62	25	27	2	5.25	2-5/8
20"	19.56	27.375	29.5	2.125	5.25	2-7/8
24"	23.5	32.875	35.5	2.625	6	3-1/2



# RAISED FACE SPECTACLE BLIND

## DIMENSIONS CONT.

PIPE SIZE	1500# FLANGES					
	A	B	C	D	E	F
1/2"	.625	2.375	3.25		1.5	0.25
3/4"	0.82	2.625	3.5	0.875	1.625	0.375
1"	1.05	3	4	1	2.5	0.375
1-1/4"	1.375	3.375	4.375	1	2.5	0.375
1-1/2"	1.61	3.75	4.875	1.125	2.75	0.5
2"	2.07	5.5	6.5	1	2.75	0.5
2-1/2"	2.47	6.375	7.5	1.125	3	0.63
3"	3.07	6.75	8	1.25	3	0.75
4"	4.03	8.125	9.5	1.375	3.5	0.88
5"	5.05	9.875	11.5	1.625	3.5	1-1/8
6"	6.06	11	12.5	1.5	3.5	1-3/8
8"	7.98	13.75	15.5	1.75	4	1-5/8
10"	10.02	17	19	2	4.5	2.00
12"	11.94	20.375	22.5	2.125	4.5	2-3/8
14"	13.12	22.625	25	2.375	5	2-5/8
16"	15	25.125	27.75	2.625	5.25	3
18"	16.88	27.625	30.5	2.875	5.75	3-3/8
20"	18.81	29.625	32.75	3.125	6	3-3/4
24"	22.62	35.375	39	3.625	7	4-3/8

PIPE SIZE	2500# FLANGES					
	A	B	C	D	E	F
1/2"	.625	2.625	3.5		1.5	0.375
3/4"	0.82	2.875	3.75	0.875	1.625	0.375
1"	1.05	3.25	4.25	1	2.5	0.375
1-1/4"	1.38	4	5.125	1.125	2.5	0.5
1-1/2"	1.61	4.5	5.75	1.25	2.75	0.625
2"	2.07	5.625	6.75	1.125	2.75	0.625
2-1/2"	2.47	6.5	7.75	1.25	3	0.75
3"	3.07	7.625	9	1.375	3	0.875
4"	4.03	9.125	10.75	1.625	3.5	1-1/8"
5"	5.05	10.875	12.75	1.875	3.5	1-3/8"
6"	6.06	12.375	14.5	2.125	3.5	2
8"	7.81	15.125	17.25	2.125	4	2-1/8"
10"	9.75	18.625	21.25	2.625	4.5	2-5/8"
12"	11.37	21.5	24.375	2.875	4.5	3-1/8"